



INSTRUCTIONS

DAC

20th Anniversary D/A Convertor

Attention: Your product is marked with this symbol.

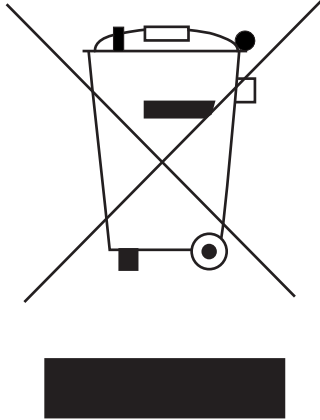

It means that used electrical and electronic products should not be mixed with general household waste. There is a separate collection system for these products.

A. Information on Disposal for Users (private household).

1. In the European Union

Attention: If You want to dispose of this equipment, please do not use the ordinary dust bin.

Used electrical and electronic equipment must be treated separately and In accordance with legislation that requires proper treatment, recovery and recycling of used electrical and electronic equipment.

Following the implementation by member states, private household within the EU states may return their used electrical and electronic equipment to designated collection facilities free of charge*. In some countries* your local retailer may also take back your local authority for further details.

If you used electrical or electronic equipment has batteries or accumulators, please dispose of these separately beforehand according to local requirements.

By disposing of this product you will help ensure that waste undergoes the necessary treatment, recovery and recycling and thus prevent potential negative effects on the environment and human health which could otherwise arise due to inappropriate waste handling.

2. In the other Countries outside EU

If you wish to discard this product, please contact your local authorities and ask for the correct method of disposal.

For Switzerland: Used electrical or electronic equipment can be returned free of charge to dealer, even if you don't purchase a new product. Further collection facilities are listed on the homepage of www.swico.ch or www.sens.ch.

B. Information on Disposal of Business Users

1. In the European Union

If the product is used for business and you want to discard it:

Please contact local dealer who will inform you about the take-back of the product. You might be charged for the costs arising from take-back and recycling. Small products (and small amounts) might be taken back by your local collection facilities.

2. In the other Countries outside the EU

If you wish to discard of this product, please contact your local authorities and ask for the correct method of disposal.

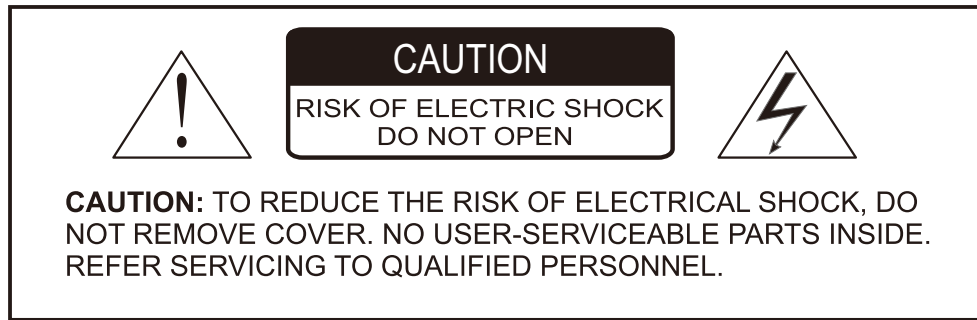

The exclamation point within an equilateral triangle is intended to alert the user to presence of important operating and maintenance (servicing) instructions in the literature accompanying the appliance.



The lightning flash with arrowhead symbol, within an equilateral triangle, is intended to alert the user to presence of uninsulated “Dangerous voltage” within the product’s enclosure that may be of sufficient magnitude to constitute a risk of electric shock to persons.

Before Use

Please read all instructions and precautions carefully and completely before operating this device.

1. Read these instructions.
2. Keep these instructions.
3. Heed all warnings.
4. Follow all instructions.
5. Do not use this apparatus near water.
6. Clean only with dry cloth.
7. Always keep this unit out of the reach of children.
8. Do not install near any heat sources such as radiators, heat registers, stoves, or other apparatus (including amplifiers) that produce heat.
9. Protect the power cord from being walked on or pinched particularly at plugs, convenience receptacles, and the point where they exit from the apparatus.
10. Unplug this apparatus during lightning storms or when unused for a long time.
11. Always disconnect your entire system from the AC mains before connecting or disconnecting any cable, or when cleaning any component.
12. This product must be terminated with a three conductor AC mains power cord which includes an earth ground connection, to prevent shock hazard, all three connections must always be used.
13. AC extension cords are not recommended for use with this product.
14. Never use flammable or combustible chemicals for cleaning audio components.
15. Never operate this product with any cover removed.
16. Never pour or spill liquids directly onto this unit.
17. Never block air flow through ventilation slots or heat sinks.
18. Never bypass any fuse.
19. Never replace any fuse with a value or type other than those specified.
20. Never attempt to repair this product, if a problem occurs, contact your dealer.
21. Never expose this product to extremely high or low temperatures.
22. Never operate this product in an explosive atmosphere.

2.1 Front panel

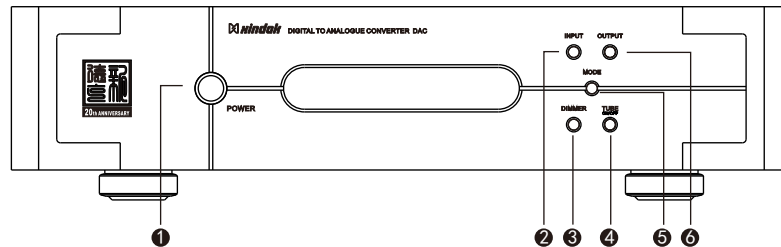
**1 Power Button:**

This button connects and disconnects the DAC from the AC mains power.

2 Input Selection Button:

Press down this button, you can select loop input signal: coaxial-optical-BNC-balance-PC USB The display screen will display the corresponding input way. At this point the unit have power off memory function.

3 Dimmer Button:

Press this button to adjust the display screen lightness circularly in 4 grades. At this point the unit have power off memory function.

4 Tube switch:

You can turn on and off the tube power through this switch. When you not need the tube amplifying output for a long time, please turn off the tube power so as to protect the tube well.

5 Mode button:

Press this button, can set the work mode as 192KHz/24bit or 96KHz/24bit. The display screen will display corresponding work mode. At this point the unit have power off memory function.

6 Output Switch:

You can chose tube amplifying and operate amplifying output through this switch. At this point the unit have power off memory function.

2.2 Rear Panel

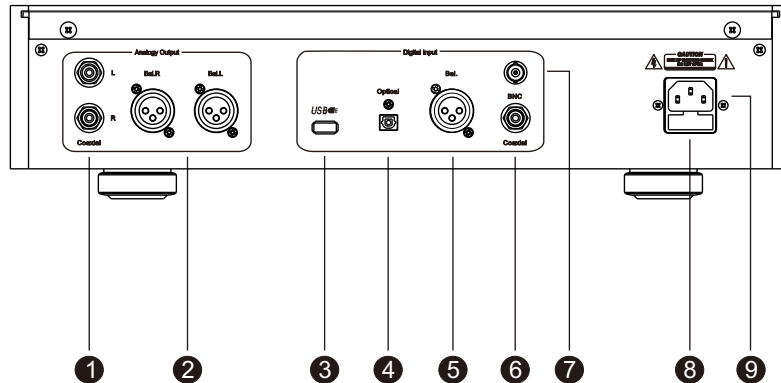
**1 RCA Audio Output Terminal**

Output the analog stereo audio signal amplified by tube to the input port on the amplifier. This output port can choose output audio signal of tube amplifying or output audio signal of operate amplifying.

2 Balanced Audio Output Terminal

Output the balanced audio signal (analog stereo) amplified by transistor to the input port on the amplifier.

3 USB Input Socket

Please connect this port to the computer by USB connection cable. (USB connection cable is not attached).

4 Digital Optical Input Terminal

It is used to input the digital audio signal. You could input the digital audio signal of the CD, VCD, DVD or the computer to this unit by Optics cable.

5 Digital balanced Input Terminal

It is used to input the digital audio signal. You could input the digital audio signal of the CD, VCD, DVD or the computer to this unit by 110Ohm balanced cord.

6 Digital Coaxial Input Terminal

It is used to input the digital audio signal. You could input the digital audio signal of the CD, VCD, DVD or the computer to this unit by 75Ohm coaxial cord.

7 Digital BNC Input Terminal

It is used to input the digital audio signal. You could input the digital audio signal of the CD, VCD, DVD or the computer to this unit by 75Ohm BNC cord.

8 Fuse Socket

Use to install the fuse.

9 AC Input Socket

Connect the power cord to the AC inlet.

2.3 For Using the Remote Controller

Install Batteries

Before using the remote controller for the first time, you need install the new battery in the remote controller.

Process

1. Use the tool to remove the rear cover of the remote control unit.
2. Install the 2 batteries (AAA) with correct +/- polarity.
3. Reinstall the rear cover of the remote control unit.

Battery Replacement

1. Use the tool remove the rear cover of the remote control unit.
2. Take out the old batteries from remote control unit.
3. Install the 2 batteries (AAA) with correct +/- polarity.
4. Reinstall the rear cover of the remote control unit.

Caution

1. Do not use new and old batteries simultaneously.
2. Batteries with similar shapes may have different rated voltage, be sure to use the correct batteries.
3. Remove batteries from the remote control unit if it will not be used for a long period of time.

Using Remote Controller

If you use the remote control unit to control the amplifier:

1. The remote control range is approximately 5 meters.
2. Pointing the remote control on an angle to the receiver, will shorten the useful distance of the remote control.

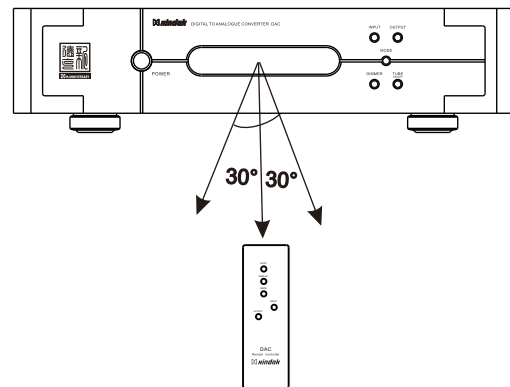
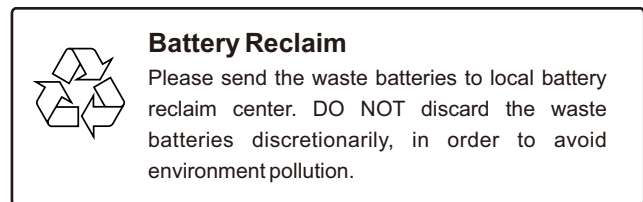
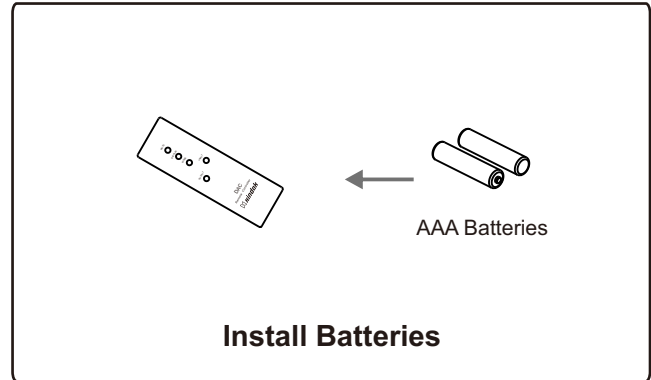



Incorrect use of batteries may cause corrosion or damage.
The lower temperature, then shorter battery life.

2.4 Remote Controller

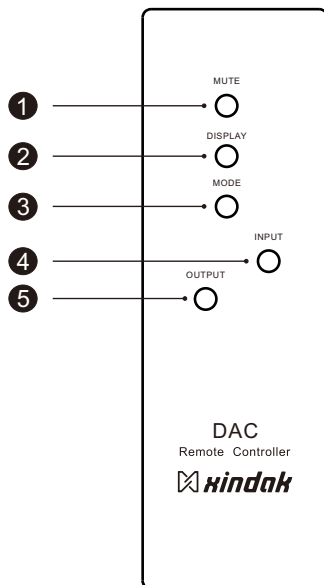
**1. MUTE Button:**

Press this button, for turn on or turn down the output volume.

When the product is in mute state, the display screen will display "VOL:---" corresponding function.

2. DISPLAY Button:

Press this button can display the current output state and tube switch state.

3. MODE Button:

Press this button, You could chose four kinds of work mode: 192kHz/32bit、 192kHz/24bit、 96kHz/24bit、 96kHz/32。 The display screen will display corresponding work mode.

4. INPUT Button:

Press down this button, you can select loop input signal : coaxial-optical-BNC-balance-PC USB.

5. OUTPUT Button:

Through the switch can choose tube amplifying output and operate amplifying output.

3.1 Specification

System:	Stereo audio digital to analog converter
Temperature:	+5°C~+35°C
Humidity	5%~85%
Power Specifications	Specified on rear panel decal
Power Consumption	Max. 24W
Frequency Range	20Hz-20KHz, 0.5dB
Dynamic Range	114dB
Signal-To-Noise Ratio	114dB(With A-Weighted)
Channel Gain Inequality	<0.05dB
Output Voltage	2V(RMS,0dB)
Compatible Receiver	EIAJ CP1201, IEC-60958, AES3,S/PDIF
Digital Input	Coaxial×1 Optical×1 Balanced×1 BNC×1 USB×1
Analog Output	Coaxial×1 (vacuum tube/transistor) Balanced ×1
Dimensions(WXHXD)	430mmx107mmx375mm
Supplied accessories	Power cord×1 Optical fiber×1 Remote Controller×1 Users' manual×1

NOTE

Specification and design subject to change without notice for improvements.



No.126, Section 2, East 1 Round Chengdu, Sichuan, China P.C. 610051

You can find your nearest authorized distributor and more product information on our website:
www.xindak.com



Printed in China